



SISTEM-AIR

CENTRAL VACUUM SYSTEMS

By Tecnoplus s.r.l.

www.sistemair.com

TECHNICAL MANUAL



Autocleaner

universal system



Autocleaner Autocleaner Autocleaner Autocleaner Autocleaner
Autocleaner Autocleaner Autocleaner Autocleaner Autocleaner
Autocleaner Autocleaner Autocleaner Autocleaner Autocleaner
Autocleaner Autocleaner Autocleaner Autocleaner Autocleaner
Autocleaner Autocleaner Autocleaner Autocleaner Autocleaner



Autocleaner

Line

INSTRUCTION MANUAL

- Type: electrical air compressor, Advanced civil and industrial sector
- Model: AUTOCLEANER
- Revision 2.0.0

INDEX

1	USING THE MANUAL	2
2	DESCRIPTION OF THE SELF-CLEANING SYSTEM	3
3	TECHNICAL FEATURES	3
4	DESIGN FEATURES	4
5	SAFETY FEATURES	4
	5.1 IP Protection level	5
	5.2 Electrical insulation level	5
	5.3 Declaration of absence of harmful substances	6
	5.4 Safety devices related to fixed enclosures	6
	5.5 Safety devices related to mobile enclosures	6
	5.6 Nameplate	6
6	INTENDED USE	7
7	NOT INTENDED USE	7
8	KIT AND ACCESSORIES	8
9	INSTALLATION	8
	9.1 Getting Started	8
	9.2 Positioning	9
	9.3 Pneumatic connection	10
	9.4 Electrical connection	10
10	STARTING THE MACHINE	11
	10.1 Control settings	11
11	USING THE SELF-CLEANING SYSTEM	11
	11.1 Central vacuum cleaner computer programming and use	11
12	MAINTENANCE	12
	12.1 Ordinary scheduled maintenance	12
13	REPAIRS AND SPARE PARTS	12
	13.1 Intervention criteria	12
	13.2 Recommended Parts	12
	13.3 Decommissioning of the self-cleaning system	13
14	NOISE EMISSIONS	13
14	VIBRATIONS	13
16	TROUBLESHOOTING	13
	APPENDIX A	14
	APPENDIX B	17
	APPENDIX C	23
	APPENDIX D	26



Autocleaner

Line

INSTRUCTION MANUAL

- Type: electrical air compressor, Advanced civil and industrial sector
- Model: AUTOCLEANER
- Revision 2.0.0

PRESENTATION

Dear Customer,

TECNOPLUS Srl, owner of the AIR SYSTEM brand, first of all want to thank you for the choice you made in buying AUTOCLEANER, the innovative universal automatic cleaning system for central vacuum cleaner filters, which with the features you will find in this manual, we are sure will meet your needs. AUTOCLEANER was entirely designed and built in total conformity with the Machinery Directive 2006/42 / EC (Italian transposition with D.lgs.17 / 10), the Low Voltage Directive 2006/95 / EC, the Electromagnetic Compatibility Directive 2004/108 / EC, with top quality materials and with special efforts aimed at the maximum possible reduction of risk of injury.

Thus, we have written this manual in order to provide you with appropriate instructions for the proper use and proper maintenance which are essential for your safety, for the proper functioning and consequently for long machine life.

Please be sure to read this manual carefully and completely, to follow the instructions contained herein strictly and above all, for safety reasons not to take any kind of action that is not specifically mentioned.

GENERAL INFORMATION

1 - USE OF THE MANUAL

The instruction manual is a document prepared by the manufacturer and is an integral part of the self-cleaning system. In the event that it is resold, rented or given to others, it must be delivered to the new user or owner.

It is recommended to use it and to carefully preserve it during the entire operational life.

The main objective of this manual is to offer information on the proper equipment usage, so that you can obtain the best performance by keeping it in perfect, safe working condition.

No part of this publication may be reproduced, copied or transmitted by any means, without the written permission of TECNOPLUS LTD, owner of the AIR SYSTEM brand. The TECNOPLUS LTD company reserves the right to make improvements or changes to this manual, or to the equipment at any time, without obligation to give prior notice to third parties.

To obtain the best results, we recommend the use of genuine SYSTEM AIR consumables.
The SISTEM AIR trademark mentioned herein is a trademark and belongs to the owner TECNOPLUS srl.

2 - INTRODUCTION TO SELF-CLEANING SYSTEM

The constant research applied to central vacuum systems, assisted by high quality electronic technology, has allowed TECNOPLUS srl to produce the AUTOCLEANER automated filter cleaning system. The cleaning system is designed to simplify and maximise standard installation care, in fact AUTOCLEANER can be installed on the central vacuum unit, both during initial assembly of the power plant and in the "after market" or as an extra (optional) accessory, which can be applied to the following models:

- Tecno Star Dual Power
- Line Revo Block Professional
- Industrial Clean Line

The connection to the central vacuum cleaner is made by connecting the compressed air hose to the central unit and inserting the multipolar electrical connector into the socket provided on the vacuum unit.

3 - TECHNICAL SPECIFICATIONS

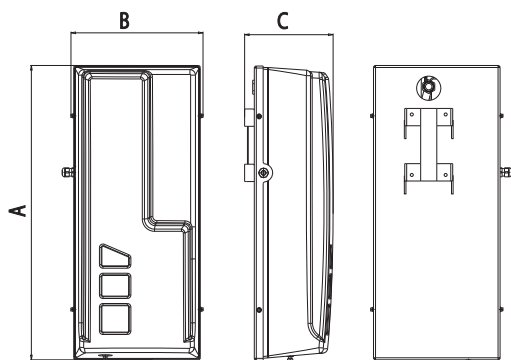

Autocleaner		
Model Article		Autocleaner
		3600.0U
Air outlet	Ø"	3/4
Protection level	IP	40
Supply	V ac	220/240
Frequency	Hz	50/60
Power	W	250
Absorption	A	1,3
Air pressure	bar	3,5
Cylinder capacity	l	6
Measure A	mm	730
Measure B	mm	328
Measure C	mm	220

4 - CONSTRUCTION FEATURES

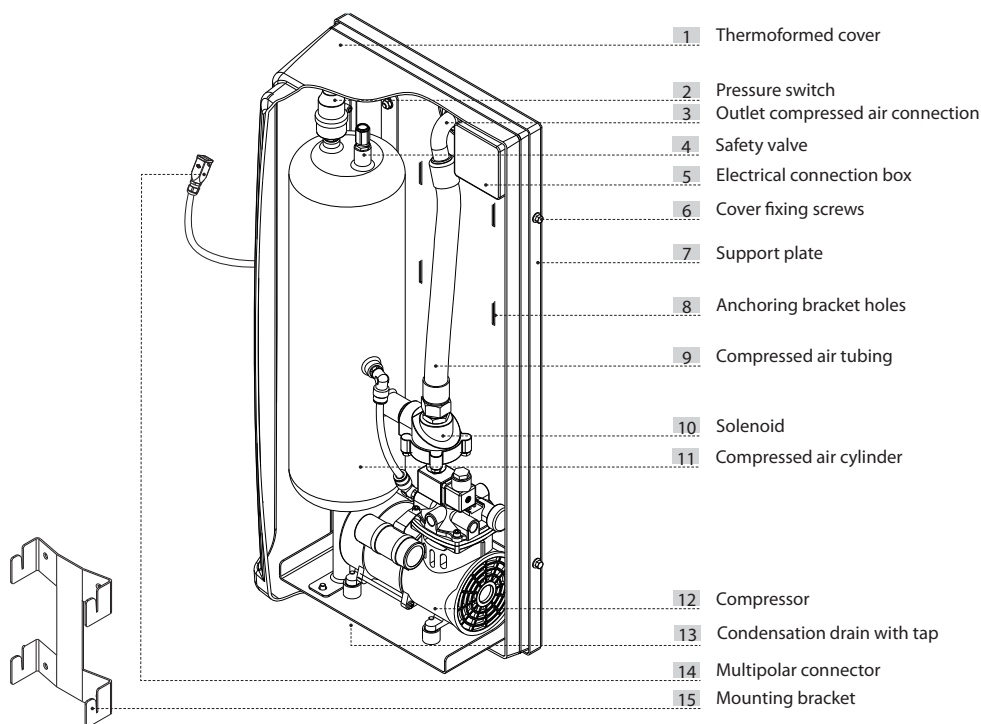

5 - SAFETY FEATURES

With regard to the 2006/42 / EC Directive of the machine safety regulations text (Italian transposition with D.lgs.17 / 10), the Low Voltage Directive 2006/95 / EC, the Electromagnetic Compatibility Directive 2004/108 / EC, the AUTOCLEANER type machine adopts the standards established for air compressors, EN 60335-2- 34 (2003), safety of electrical appliances for household and similar use (part 2) specific rules for the compressors.

Lastly, the pressure tank does not fall under Directive 97/23 (PED) as the product of their volume for the operating pressure fits into a device that is subject to article 3, paragraph 3, of that Directive, or AIR SYSTEM guarantees the sound engineering practice to ensure the safe use and therefore the intervention of 'Notified entity' is not foreseen.

It is recommended to read all the information contained in this manual regarding the installation, use and maintenance carefully.

In addition you should always observe the following WARNINGS:

- Do not use the machine for improper use.
- Do not allow children near the AUTOCLEANER system, or to play with it, while in use.
- This device should not be used by people (including children) with reduced physical, sensory or mental capabilities, or lack of experience and knowledge, unless there is supervision or instruction, concerning use of the appliance by a person responsible for their safety..
- Children should be supervised to ensure they do not play with the appliance.
- Immediately remove the connection cable to the vacuum unit in the event that:
 - The connecting cable is frayed or damaged.
 - The central unit with self-cleaning system is exposed to rain or excessive moisture.
 - The central unit or self-cleaning system have suffered a knock, or the Auto Cleaning system casing is damaged.
 - It is suspected that the central unit or the self-cleaning system are in need of maintenance or repair.
- Wear protective gloves when performing maintenance work.
- Use only original spare parts.

Finally, please note that pictographs or reports of danger and prohibition are found on parts of the equipment which, if the conditions dictated by the reports are not complied with, it is very likely to encounter risky situations.

WARNING: The company TECNOPLUS S.R.L. disclaims any form of liability or warranty if the buyer, or anyone else makes changes, or even minor modifications to the product as purchased.

The apparatus thus conceived and developed is able to best meet needs in terms of quality and application for both domestic and industrial vacuum markets.

All materials and components used for its construction meet the CE safety standards and TECNOPLUS S.R.L. have their certificates filed at their headquarters.

5.1 IP protection level

IP 40: unit with protection against solid bodies larger than 1 mm and not protected against water penetration.



5.2 Electrical insulation level

Device with fundamental electrical insulation.

It must be connected to the earth circuit of General Electric.



5.3 Declaration of absence of harmful substances

TECNOPLUS srl declares that its products are made with materials and equipment that respect the limits set by current regulations regarding protection of health and the environment and do not contain substances classified as SVHC (Substance of Very High Concern), in accordance with the EC Regulation 1907/2006 (REACH, namely registration, evaluation, authorization of chemical substances; Registration, Evaluation, Authorization, and Restriction of Chemical substances). Although in the working cycles of raw materials and our products such substances are not used, their presence in ppm (Parts per million) cannot be ruled out, due to the micro-pollution of the raw materials.

5.4 Safety related to fixed enclosure devices

The self-cleaning system is shipped to the customer with its main body fully assembled, the moving parts (compressor) are also protected by a mesh. This mesh is not accessible by the operator. In addition, access to electrical parts is protected by removable cover (thermoformed cover) by attachment only with Torsen screws.

Any intervention should be done by qualified operators and with the electrical installation isolated by detachment of the multipole connector.

5.5 Safety devices related to removable enclosure guards

There are no removable enclosure guards, each guard is considered as a fixed guard, fixed by selected screws. TECNOPLUS LTD reminds you that it is strictly forbidden to replace the screws used in the design and construction of the machines, with others of different characteristics.

TECNOPLUS LTD will immediately suspend the product warranty in case of customer tampering.

5.6 Nameplate

There is an EC identification label present on the side of the autocleaning system. Do not remove or damage the label.

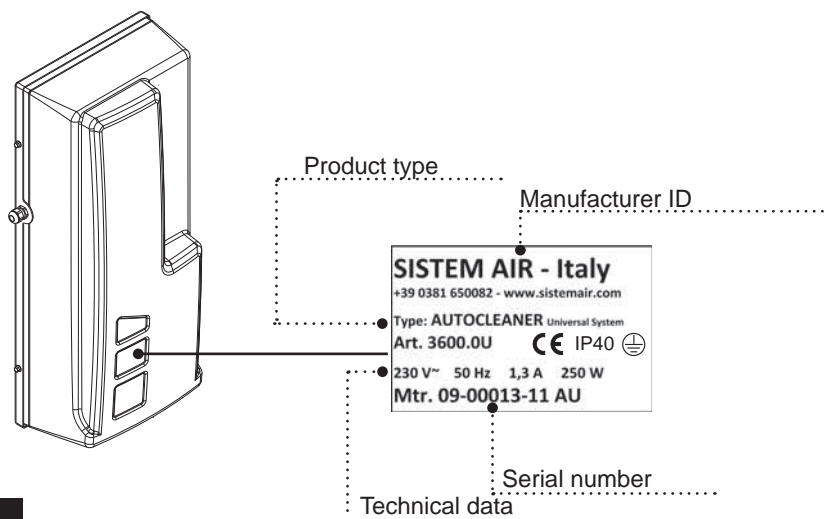

6 - INTENDED USE

The device is intended to be mounted exclusively on Sistem Air centralised vacuum systems and specifically only on models:

- Tecnostar Dual Power
- Revo Block Professional (full range)
- Industrial clean (all models)

The purpose of the cleaning system is to automatically clean the internal filter contents of the central vacuum system.

Such cleaning is conducted by passing a quantity of pressurized air through the filter itself, discharged from the cleaning system through a special pipe.

This air having previously been compressed by an electric compressor and stored inside a reservoir of 6L capacity.

The tank is equipped with a pressure switch for calibration and measurement of the internal pressure (3.5 bar) and a safety valve for the maximum permissible pressure.

The compressor activation management to load the tank is dictated by cleaning frequency and managed by the electronic board. This is mounted directly on the vacuum unit, to which AUTOCLEANER is directly connected, via a multi-polar connector cable.

The connection cable, in addition to bringing the power supply, also carries the activation signal.

7 - NON INTENDED USE

It is very important NOT to use the appliance in the following ways, considered improper and dangerous: The device is not designed for use in environments in danger of explosion, therefore:

- It is strictly forbidden to use the self-cleaning system in an explosive atmosphere, or outside the standard values of temperature, pressure and humidity.

Uses other than those listed above are not permitted.

Any adaptation or modification of the cleaning system (or components) is absolutely prohibited. Any use other than that for which AUTOCLEANER was built is an abnormal condition, which may cause damage to the equipment and constitute a serious risk for the user.

8 - KIT AND ACCESSORIES

The central system package as sold includes the accessory kit, composed of the following items:

- 1) 1 x support bracket
- 2) 1 x gasket (for pneumatic connection)
- 3) 1 x Installation, Use and Maintenance Manual
- 4) 1 x Autocleaner

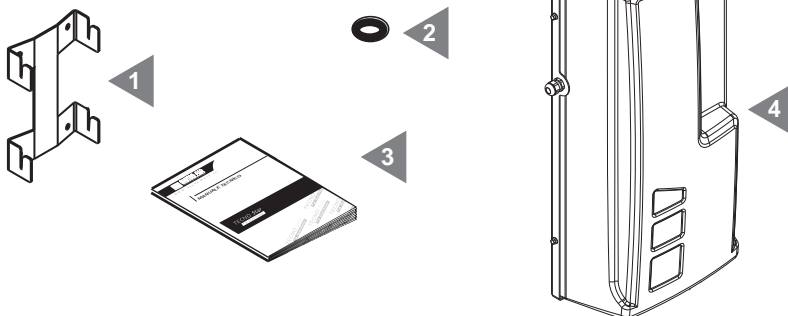

Verify that the central unit and its accessory kit correspond to that ordered and that there is no obvious transport damage.

Otherwise, please contact the dealer.

9 - INSTALLATION



- CAUTION -
THESE OPERATIONS MUST BE PERFORMED
BY QUALIFIED PERSONNEL

9.1 Preparatory operations

AUTOCLEANER is shipped fully assembled and packed.

Some checks should be performed, before proceeding to start up the unit:

- Verify the integrity of the packaging.
- Check that the machine does not present more or less obvious damage, in particular check that any protruding parts are intact.
- Verify the integrity of the connection cable and multipolar connector.
- Check the presence of the mounting bracket and the necessary associated installation screws.
- Check the presence of the Certificate of Guarantee.

In case of finding damage, anomalies or omissions, do not proceed with the installation, but consult the Retailer, or TECNOPLUS S.R.L. directly.

9.2 POSITIONING

Remove the 4 screws on the back of the cylinder and use them to fix the Autocleaner mounting bracket. Remove the thermoformed plastic cover, using the Torsen screws.

1

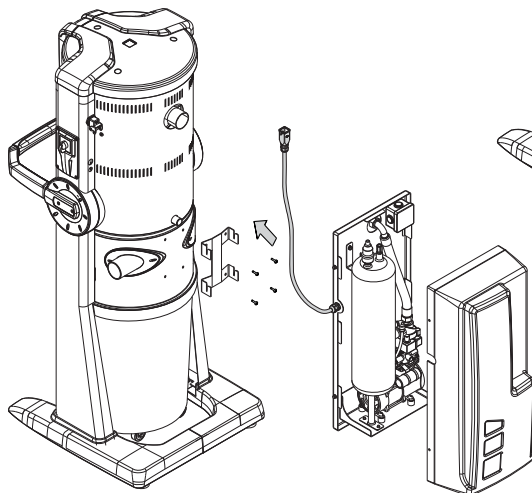
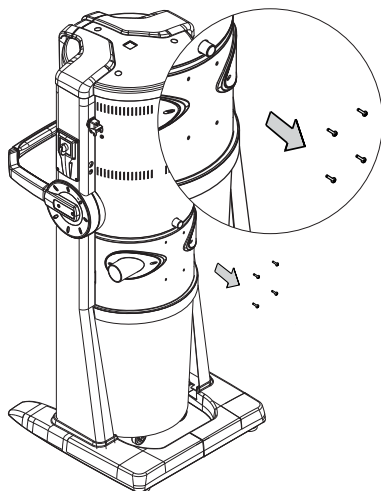

2

Secure the bracket to the central unit with the 2 screws removed earlier.

Hook the Autocleaner frame onto the support bracket, sliding the centering plates into the slots on the frame.

3

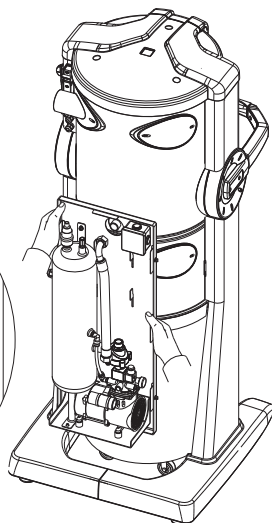
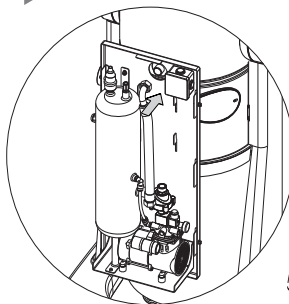

9.3 Pneumatic connection

Bring the compressed air hose fitting to the socket on the rear of the central unit.

1

N.B . Ensure that the supplied sealing gasket is properly positioned between the male and female fittings.

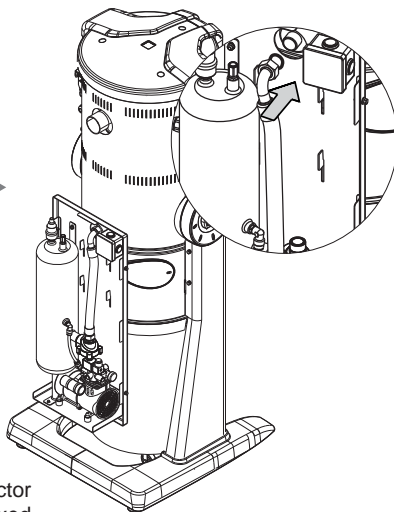

2

Screw the connector (female), onto the fixed socket (male), ensuring it is tightly fixed. Close the thermoformed cover.

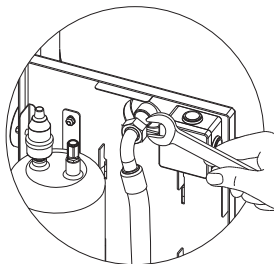

9.4 Electrical connection

1

Remove the cap of the central vacuum unit connector.

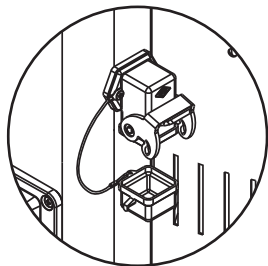

Connect the multipolar connector with the socket mounted on the Autocleaner system and close the safety lock, making them solid.

2

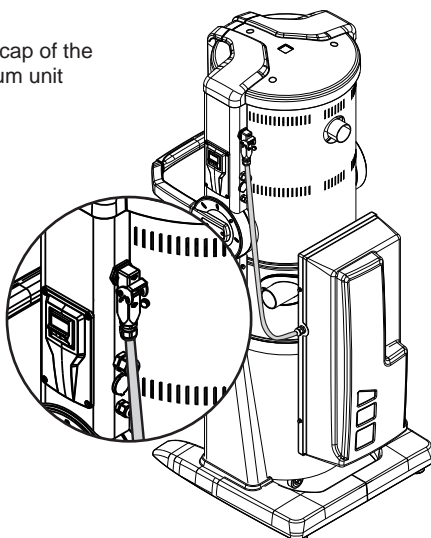

10 - MACHINE COMMISSIONING

10.1 Control settings

The AUTOCLEANER system is managed entirely by the central unit display.

11 - USING THE SELF-CLEANING SYSTEM

The AUTOCLEANER system, when connected to the power plant, is managed directly by the parameters as set on its central display.

The maintenance, or cleaning frequency is automatically set by the software.

11.1 Programming and use of the central vacuum cleaner computer

The central vacuum and the dust separators are equipped with a practical display.

Using this display, commands can be sent to the central management computer, or changes to the basic settings of the Autocleaner cleaning system can be made.

See **APPENDIX A** for the following items:

3200.1B
3200.2B
3200.3B
3200.4B
3200.5B
3200.6B
3400.0
3400.1

See **APPENDIX B** for the following items:

3203.1B
3203.2B
3203.3B
3203.4B
3203.5B
3203.6B
3403.0
3403.1

See **APPENDIX C** for the following items:

3116.2TS (year of manufacture 2011 - 06/2014)

See **APPENDIX D** for the following items:

3116.2TS (year of manufacture 06/2014 - to date)

12 - MAINTENANCE



BEFORE ANY MAINTENANCE OPERATION, IT IS COMPULSORY TO DISCONNECT THE MAINS POWER SUPPLY CABLE, WEARING GLOVES AND PROTECTIVE MASK

12.1 Ordinary scheduled maintenance

The self-cleaning system does not require a routine maintenance program. However, it is recommended to perform certain operations for the proper functioning of the device, such as visual inspection of the proper functioning of the condensation drain and cleaning of the compressor impeller fan grill.

13 - REPAIR AND SPARE PARTS

13.1 Intervention criteria



It is strictly prohibited to work on AUTOCLEANER for any repairs and/or maintenance, which is not expressly authorized in this manual.

All damage or malfunction repairs must be performed by qualified service staff.

In the case of interventions by unauthorized personnel, any product warranty will become void, releasing the manufacturer from any liability for any damage to people and/or things resulting from such intervention.

13.2 Recommended Spares

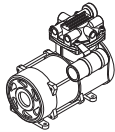
There are no consumable parts. However, it still a useful practise to refer to the following table to order spare parts.

DESCRIPTION	CODE REPLACEMENT	
Compressor	9910.405	
Solenoid	9910.402	
Pressure switch	9910.400	

13.3 Decommissioning of the self-cleaning system.

If you decide to take the AUTOCLEANER out of service, it must be done with respect to our health and the environment in which we live. Disposal and/or recycling of any central unit component must be carried out in accordance with applicable laws.

14 - SOUND EMISSION

Mounted directly on a vacuum unit, a sound meter test was performed by measuring the sound pressure and the acoustic power of the self-cleaning system during normal operation. The test report is held at TECNOPLUS srl.

15 - VIBRATIONS

There is no hand-arm or whole body contact between the operator and the machine during the vacuum operation through the flexible hose, thus there are no vibrations. There is therefore no relative risk.

16 - TROUBLESHOOTING

PROBLEM	CAUSE	REMEDY
The Autocleaner system will not start	Alarm on your computer	Perform RESET alarm and any required related maintenance
	The Autocleaner system has not been activated on your computer	Follow the activation procedure by consulting your equipment manual
	No electrical connection	Connect the multipolar connector to the machine socket
Pressure switch alarm	The pressure switch did not allow the Autocleaner system to start	Use the condensation drain tap to empty the air tank, call the service center

APPENDIX A

Programming relative to bringing the self-cleaning system into service on the central unit:

Revo Block Professional





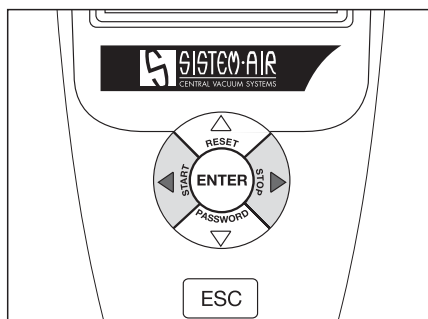

3200.1B
3200.2B
3200.3B
3200.4B
3200.5B
3200.6B

Industrial Clean

3400.0
3400.1



Data entry is done in the following way:

- Pressing the up  and down  arrow, you can scroll within the display screen
- Pressing enter  will then store the data entered, or selection made
- Press the left  and right  arrow, to change the value that appears on the display
- Pressing "esc",  exits the display screen or stores the selected choice

26/07/2011	10:00
Vacuum OFF Depression 0 mbar	
▼▲	

Set point depress.
Info/alarm
Date/Time Setting Machine lock
set
Press Enter ▼▲

Param. INSTALLATION
Data transmission
Reset parameters
Testing and check
Press Enter ▼▲

Mode SELECTION
Filter Cleaning:
Manual
Autocleaner (optional)
Press Enter ▼▲

Set point depress.
Info/alarm
Date/Time Setting
Machine lock set
Press Enter ▼▲

Power Alarm
Maintenance alarm
Filter alarm
Alarm autocleaner
Press Enter ▼▲

1 Main screen.
Press the down arrow to access the main menu.

2 Using the up/down arrows, select the **PARAM.INSTALLATION** option.
Press **ENTER** to enter the menu below.

3 Scroll through the screens until the screen displayed. Using the up/down arrows, select **AUTOCLEANER (OPTIONAL)**. Press **ENTER** to store the data.
Press **ESC** to return to the main menu.

4 Using the up/down arrows, select **MACHINE LOCK SET**
Press **ENTER** to enter the menu below.

5 Using the up/down arrows, select **AUTOCLEANER ALARM**.
Press **ENTER** to enter the menu below.

Timer autocleaner: 1 1 40h min.....max
Press Enter ▼▲

N°AUTOCLEANER CYCLES:1 1 10 min.....max
Press Enter ▼▲

ACTIVATION autocleaner: Daytime
DAILY SCHEDULE
Press Enter ▼▲

Daily schedule: 08:00 20:00 Start finish
Press Enter ▼▲

Enable machine lock with Autocleaner YES NO
Press Enter ▼▲

6

TIMER TAUTCLEANER: Time in hours to automatically start the system Autocleaner every X hours of active vacuuming.

Use the up/down arrows to change the operating time of Autocleaner system. Press **ENTER** to go to next screen

7

N° AUTOCLEANER CYCLES: Number of continuous Autocleaner system activations. Use the up/down arrows to change the number of Autocleaner system activations. Press **ENTER** to go to next screen

8

ACTIVATION AUTOCLEANER: Daylight time - Autocleaner system can operate from 08:00 to 20:00.

Daily schedule: Autocleaner system permitted operation 24/7.

Use the up/down arrows to select the desired item.

Press **ENTER** to go to next screen.

9

In the case where daily schedule has been selected, use the up/down, L and R arrows, to edit the times as required by the user. Press **ENTER** to go to next screen.

10

By selecting **YES**, the system automatically stops the vacuum and activates the filter cleaning. By selecting **NO** the system waits for vacuuming to stop and activates filter cleaning. Use the L and R arrows to select the desired item. Press **ENTER** to store.

APPENDIX B

Central unit data programming for putting the self-cleaning system into service:

Revo Block Professional 2016

3203.1B
3203.2B
3203.3B
3203.4B
3203.5B
3203.6B

Industrial Clean 2016

3403.0
3403.1

N.B. This central model automatically recognizes the Autocleaner cleaning system.

To enable automatic recognition of the device, make the electrical connection to the system with the power disconnected.

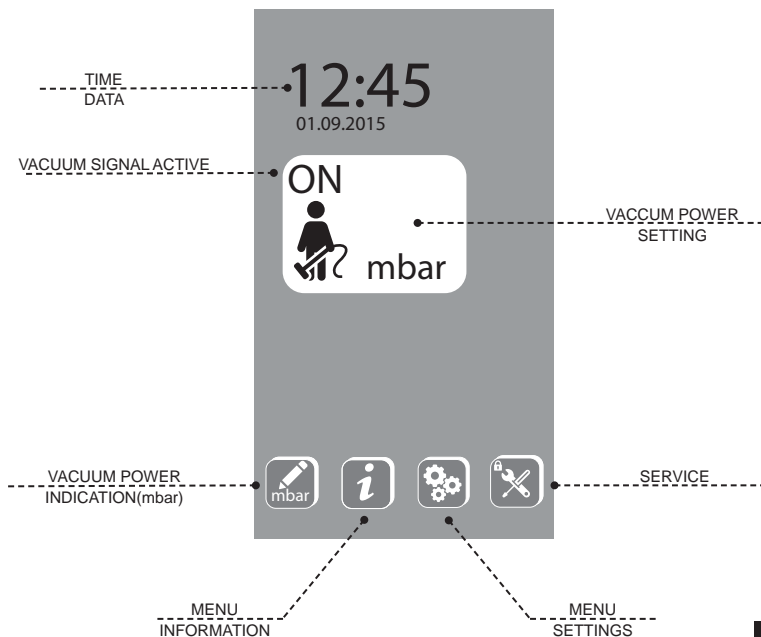



MENU INFO
Press the button to access
system information
AUTOCLEANER

AUTOCLEANER
Press the button to access
information regarding the
filtration level

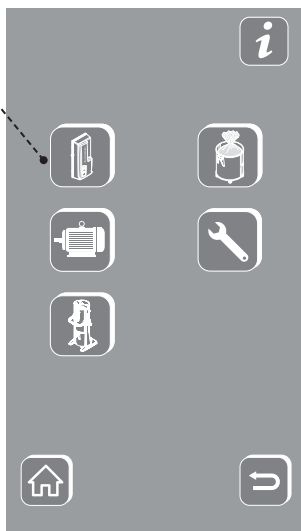

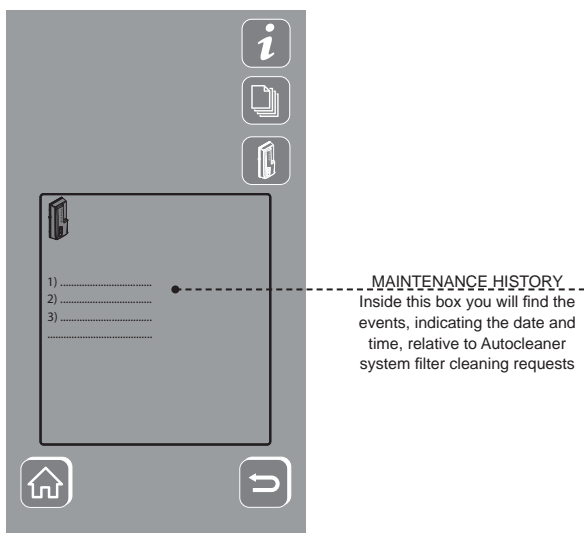
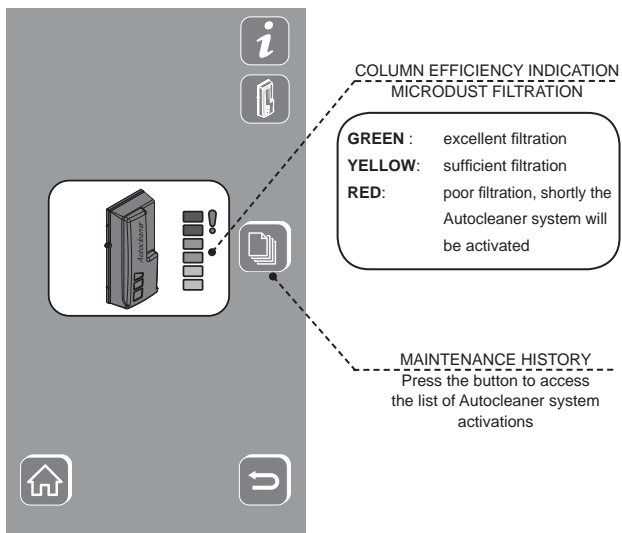



MENU SETTINGS
Press the button to access
the basic settings of the
AUTOCLEANER system

MAINTENANCE SETTINGS
Press the button to change the basic
settings of the AUTOCLEANER system





MAINTENANCE SETTINGS AUTOCLEANER

Press the button to change the timer and vacuum stop for when AUTOCLEANER system filter cleaning required

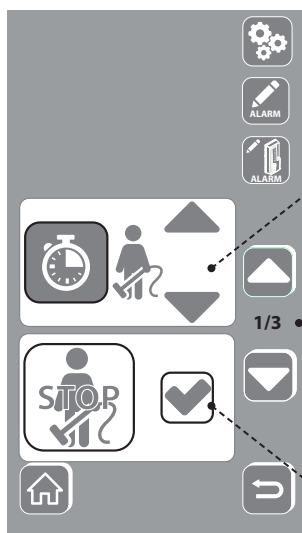

MAINTENANCE TIMER SETTINGS

Press the two buttons to adjust the vacuum hours counter, after which AUTOCLEANER system activation is required

Premere i due pulsanti per passare alle impostazioni successive o precedenti

VACUUM STOP SETTINGS

Press inside the cell to automatically activate the vacuum stop, in case of AUTOCLEANER system activation request

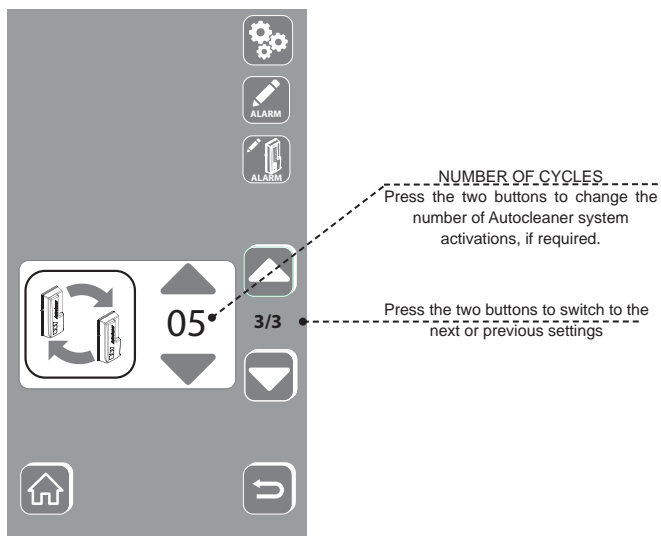
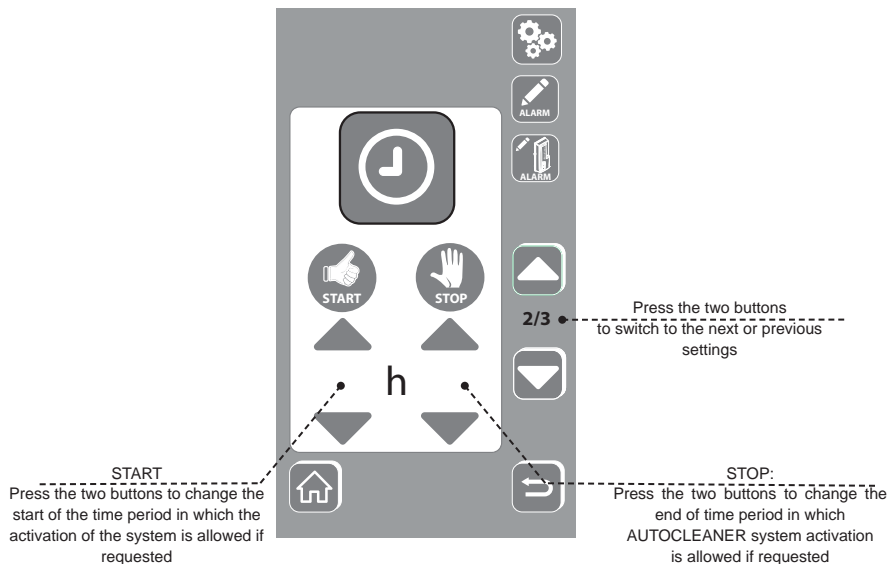

APPENDIX C

Central unit data programming for putting the self-cleaning system into service:

TECNOSTAR DUAL POWER

3116.2TS (year of manufacture 2011 - 06/2014)

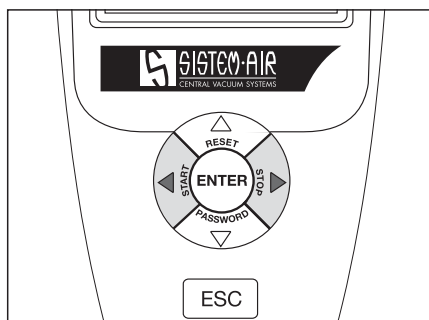

DATA INSERTION occurs as follows:

- Pressing the up down arrow, scroll within the display screen



- Pressing enter will then store the data entered, or selection made



- Press the left right arrow to change the value that appears on the display



- Pressing esc exits the display screen or stores your selection made



		26-07-11 10:00
Vacuum: OFF Depression: 0 mbar Eff. Filter: 100% Dust level: 0%		
Press Enter		

MAIN MENU
Turbo function Date/Time Setting Info/alarm Machine lock set

MAIN MENU
INSTALLATION PARAMAMETER
Data transmission Reset parameters Check and test

AUTOCLEANER SYSTEM
FUNCTION ACTIVE <OFF> Number of cycles <1> Operation <12h> TimerAutocleaner <15h>

1

Main screen.

Press the **ENTER** key to access the main menu.

2

Using the up/down arrows select **INSTALLATION PARAM.** Press **ENTER** to access the next menu.

3

Activation check relative to Autocleaner system (optional accessory):

FUNCTION ACTIVE:
OFF: Autocleaner system is not connected to the central vacuum.

ON: Autocleaner system is connected to the central vacuum.

NUMBER OF CYCLES: selection of number of continuous Autocleaner system activations.

OPERATION:
12h: The Autocleaner system will only operate from 08:00 to 20:00

24h: The Autocleaner system can operate 24 hours.

AUTOCLEANER TIMER: time in hours to automatically start the filter cleaning cycles.

Press **ENTER** to store.

Press **ESC** to return to the main menu.

MAIN MENU
Turbo function
Date/Time Setting
Info/alarm
Set machine lock

SET MACHINE LOCK
FILTER Alarm
Maintenance Alarm
DUST Alarm
Autocleaner System

Autocleaner System
Motor lock <ON> (The motor stops, the cleaning starts)

4

Using the up/down arrows select **SET MACHINE LOCK**

Press **ENTER** to enter the next menu.

5

Using the up/down arrows select **AUTO-CLEANER SYSTEM.**

Press **ENTER** to enter the next menu.

6

Selecting **ON**: the system automatically stops the vacuum and activates filter cleaning.

Selecting **OFF**: the system waits for vacuum stop to activate filter cleaning. Press **ESC** to return to the main screen.

Appendix D





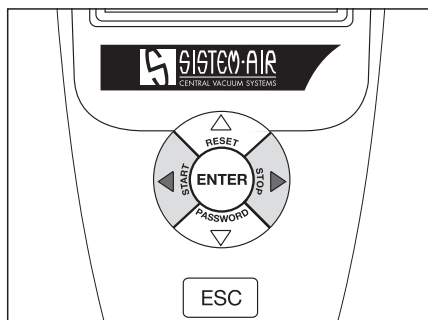

Programming to bring the central unit self-cleaning system into service:

TECNOSTAR DUAL POWER

3116.2TS (year of manufacture 06/2014 - to date)



Data insertion is done as follows:

- Pressing the up  down  arrow you scroll within the display screen
- Pressing enter  will then store the data entered, or selection made
- Press the left  and right  arrow to change the value that appears on the display
- Pressing esc  exits the display screen or stores your choice

16/09/15	10:00
Suction:	OFF
Depression:	mbar 000
Press Enter	

SETTINGS
Menu
Setup
Firmware

SETUP
Turbo function <input type="checkbox"/>
Autocleaner <input checked="" type="checkbox"/>
Parameters
Reset parameter
Language
Model

SETTINGS
Menu
Setup
Firmware

MENU
Timer dust container
Autocleaner
Suction stop
Maintenance
Info
Date/time

1

Main Screen.
Press the **ENTER** key to access the main menu.

2

Using the up/down arrows select **SETUP**.
Press **ENTER** to enter the next menu.

3

Using the up/down arrows select **AUTO-CLEANER**.
Press **ENTER** to activate device control.
Press **ESC** to return to the previous menu.

4

Using the up/down arrows select **MENU**.
Press **ENTER** to enter the next menu.

5

Using the up/down arrows select **AUTO-CLEANER**.
Press **ENTER** to enter the next menu.

AUTOCLEANER	
Cycles number	05
Start	00:00
Stop	23.59

6

Using this function you can modify the basic settings:

OFF CYCLES NUMBER: selection of number of continuous activation cycles of the Autocleaner system.

START:

Start of permitted timeframe in which Autocleaner system is activated after request

STOP:

End of permitted timeframe in which Autocleaner system is activated after request

Press **ENTER** to store.

Press **ESC** to return to the menu

Previous

Autocleaner

universal system

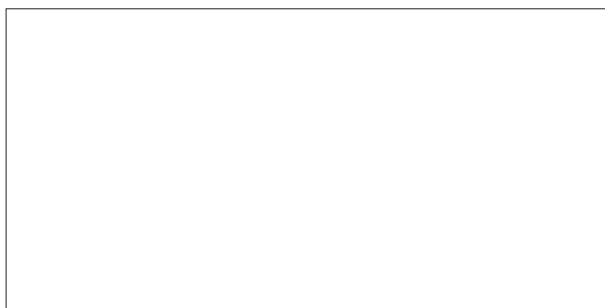

F0920065.1